

CONTINUOUS BASE ANCHOR INSTALLATION

IN USING EITHER THE CLIP OR CONTINUOUS ANCHOR INSTALLATION METHOD, THE BASE OR BOTTOM "J" ANCHOR (OR "RAIL") TYPICALLY RUNS CONTINUOUSLY ACROSS THE BASE OF THE ELEVATION (SEE "CONTINUOUS ANCHOR INSTALLATION" ON P.3.2.4-5).

FASTENER HOLES SHOULD BE DRILLED NO MORE THAN 16" OC AND CENTERED IN THE "V" GROOVE PROVIDED. FASTENER TYPE AND REQUIREMENTS SHOULD BE CONFIRMED USING THE ANCHOR LOADING TABLES IN THE ALC SOLUTION MANUAL (SEE P.3.1.3 AND 3.1.3A) OR PER AN ENGINEER'S RECOMMENDATIONS.

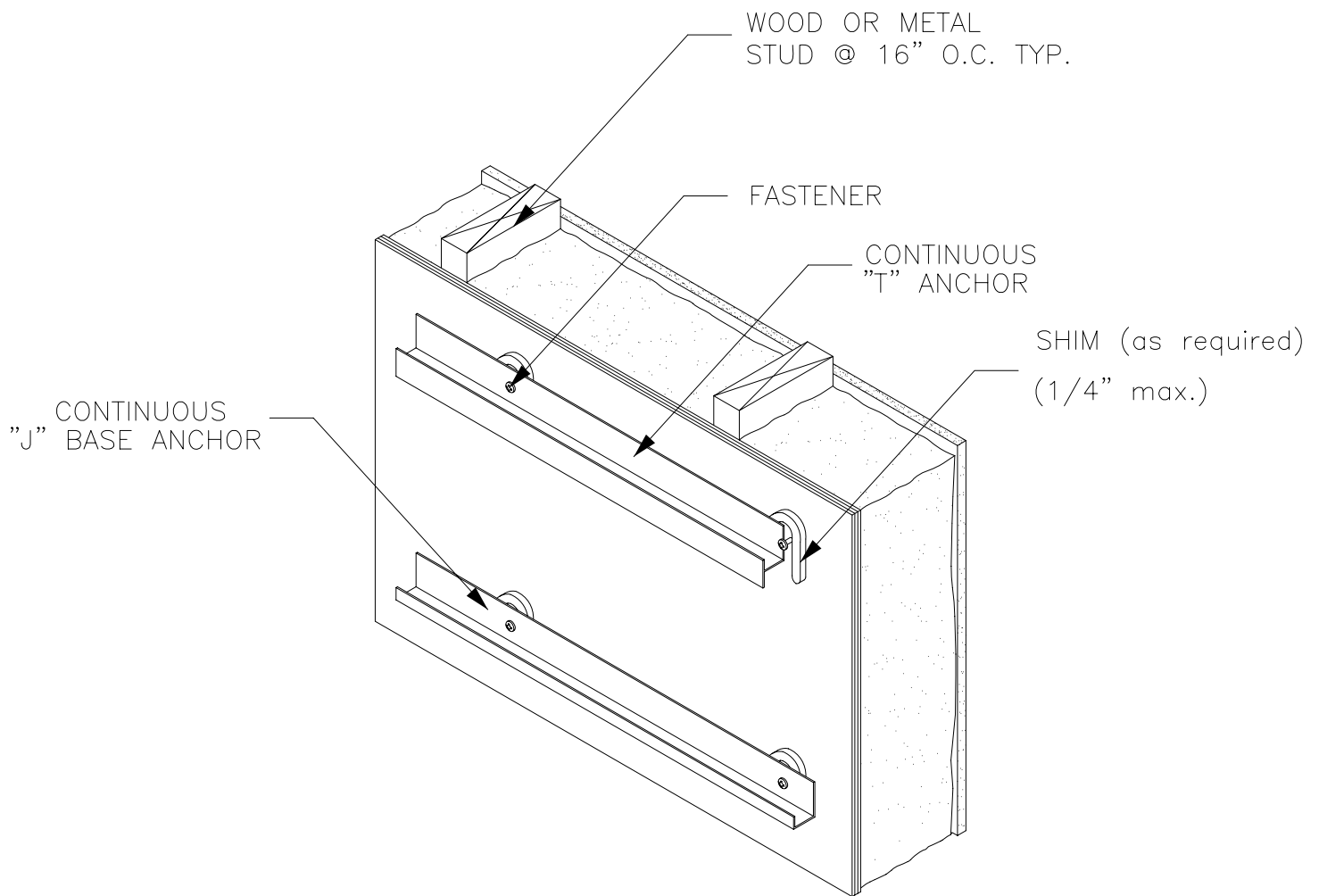

SHIMS OR SPACERS ARE USED BETWEEN THE WALL SURFACE AND ANCHOR. THESE SHIMS ARE TO BE LOCATED AT ALL FASTENERS TO PROVIDE A CONTINUOUS STRAIGHT PLANE AND TO ACCOMMODATE ANY DEVIATION IN THE FACE OF THE SUBSTRATE.

MAKE CERTAIN THAT ANCHORS ARE TRUE AND LEVEL, AND THAT ALL ANCHORS ARE VERTICALLY PLUMB.