

MANY TYPES OF PANELS CAN BE USED FOR THE EXTERIOR SHEATHING; HOWEVER THEY MUST BE APA PERFORMANCE RATED. THESE INCLUDE ORIENTED STRAND BOARD (OSB) AS WELL AS MANY GRADES OF PLYWOOD. WE WOULD PREFER:

APA STRUCTURAL 1 RATED SHEATHING EXPOSURE 1 5/8" THICK, MINIMUM.

THE PANELS SHOULD HAVE A 1/8" SPACING AT ALL EDGES AND END JOINTS. THE PANELS SHOULD BE NAILED WITH 8D NAILS SPACED AT 6" O.C. AT SUPPORTED PANEL EDGES AND 12" O.C. AT INTERMEDIATE SUPPORTS.

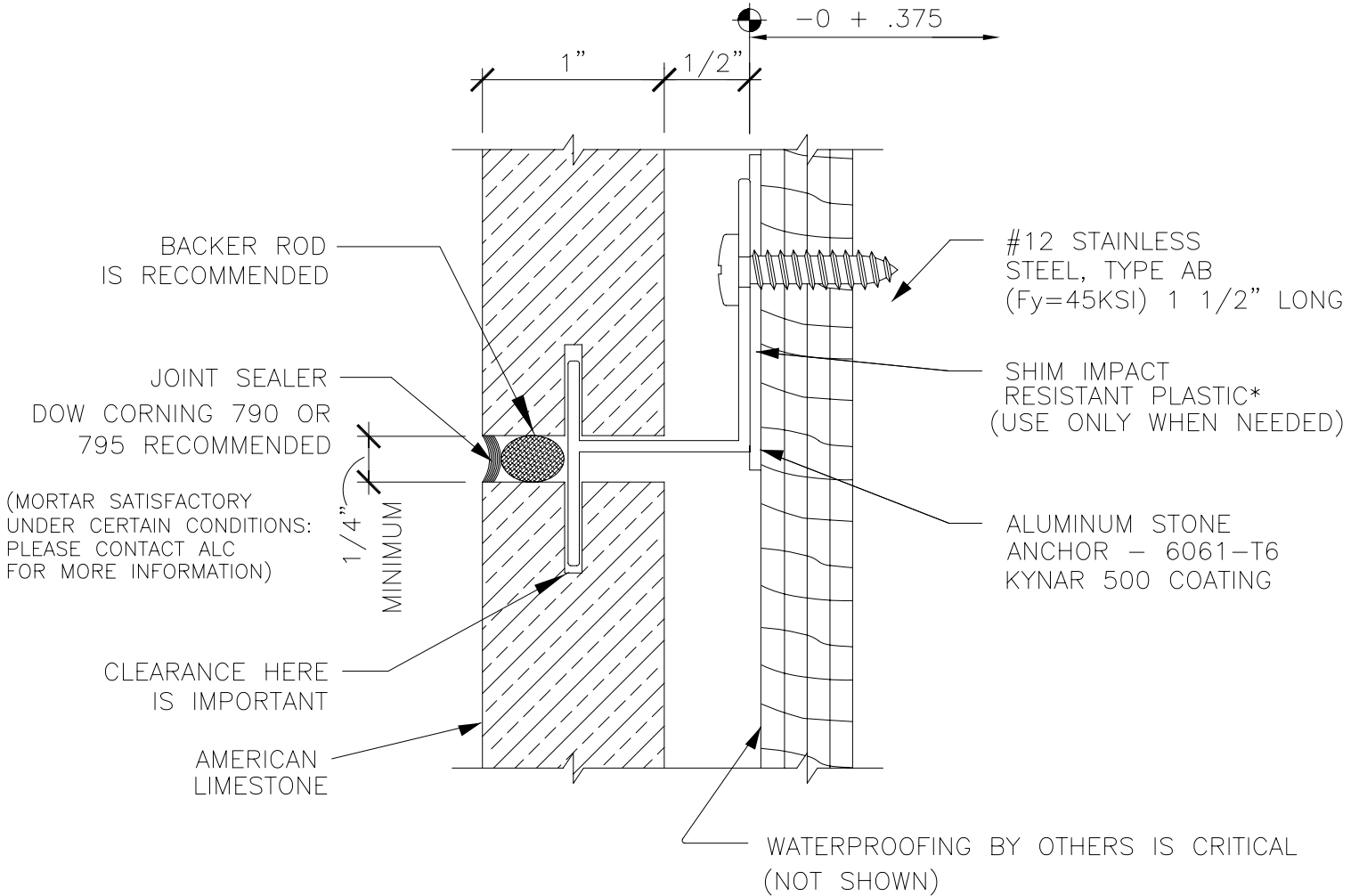

1 TYPICAL JOINT AT ANCHOR

\*IF SHIM SPACE EXCEEDS 3/8", CONSULT A PROFESSIONAL ENGINEER.

**AMERICAN LIMESTONE COMPANY**  
 A TEXAS CORPORATION  
 WWW.AMERICANLIMESTONE.COM  
 INFO@AMERICANLIMESTONE.COM

TYPICAL JOINT AT ANCHOR  
 ATTACH TO WOOD OR STEEL STUDS

**3.1.3**